

AERODROME  
CHART - ICAO

35°07'35"N  
126°48'32"E

ELEV  
48 ft / 14.5 m

TWR	118.05	236.6	254.6
GND	121.8	275.8	

GWANGJU/Gwangju

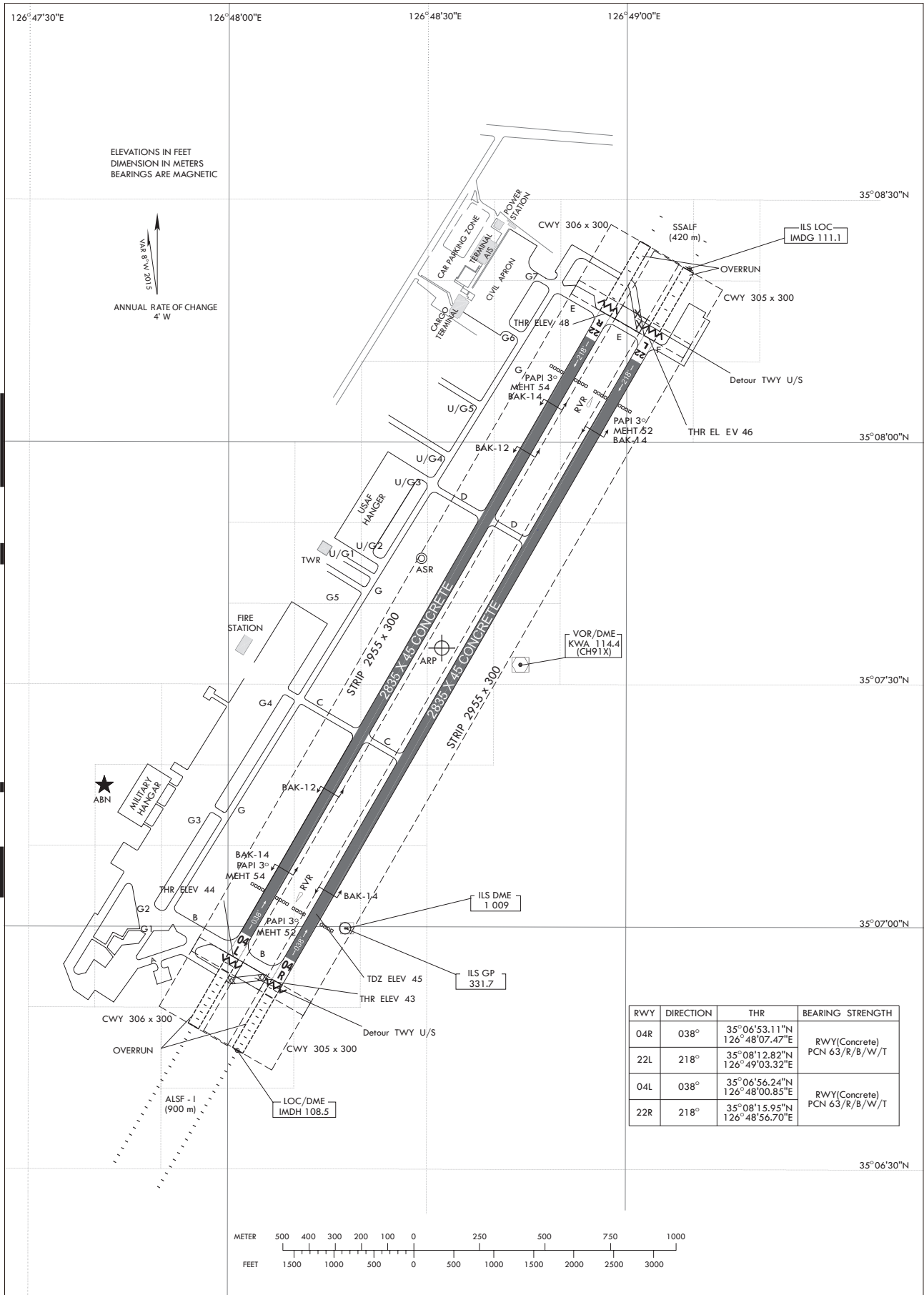

Change : Information of gates(U/1~U/5), Establishment of BAK

LIGHTING AND  
MARKING CHART

GWANGJU / Gwangju

MARKING AIDS RWY 04L/22R AND 04R/22L AND EXIT TWY

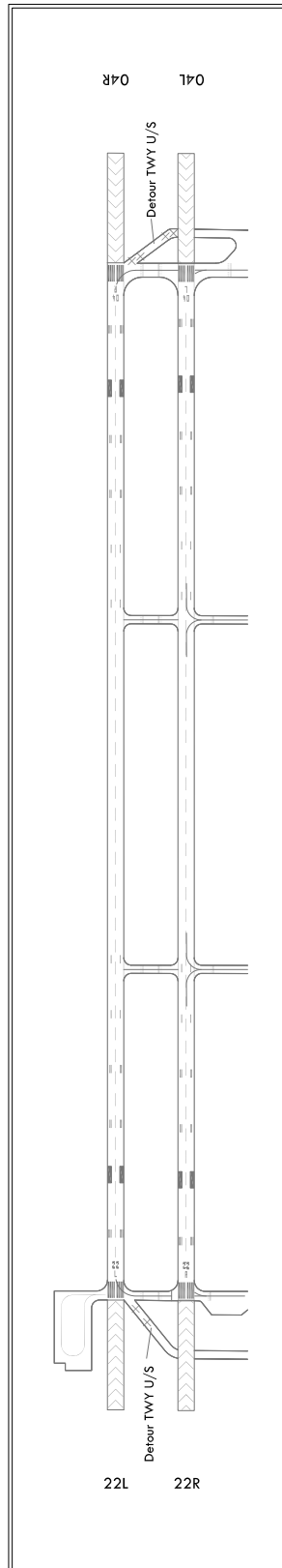

LIGHTING AIDS RWY 04L/22R AND 04R/22L AND EXIT TWY

